

# Installation Guide

SPDS10071

**Interactive 55" back-to-back freestanding kiosk**

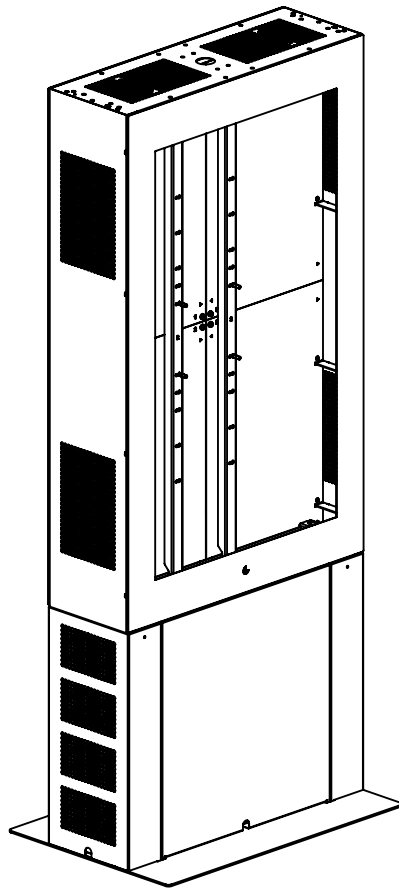



# CAUTION

- Please ensure that you read and understand the content of the installation guide before you begin the installation process.
- This product must be installed by a professional installer. More than one person needs to be involved in the installation of this product.
- Do not to overtighten the fixings.
- It is the responsibility of the installer to use the appropriate fixings for the specific installation location. Please follow the fixing suppliers recommendations for installation.
- This product is intended for indoor use only.
- This solution is designed for certified hardware and accessories. Always follow the installation guide from the hardware manufacturer for correct installation.
- The solution ventilation holes which need to remain clear and open at all times to ensure the correct operations of the screen.
- Please don't power the hardware, until the entire solution is fully assembled.
- If these installation instructions are not followed precisely, it could lead to product failure and potential personal injury.
- Ergonomic Solutions / SpacePole inc. cannot be held responsible for any product failure or personal injury, if the installation instructions are not followed correctly.
- Ergonomic Solutions / SpacePole inc. cannot be held responsible for any product failure or personal injury, if any modifications have been made to the product by the customer.

## Tool list

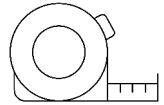
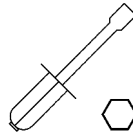
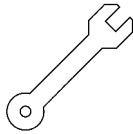
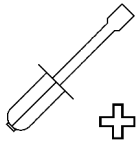

## Box content 1/3

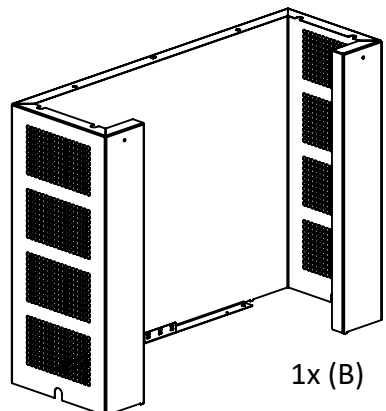
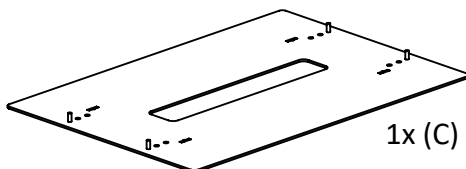
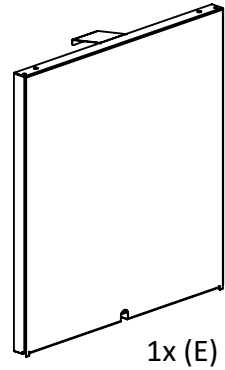
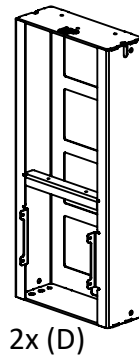
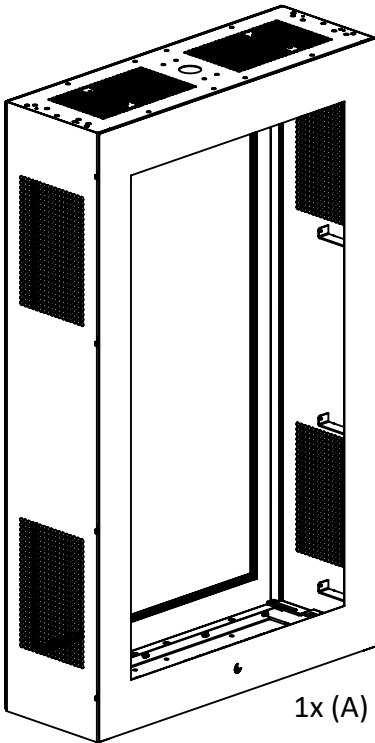

## Box content 2/3

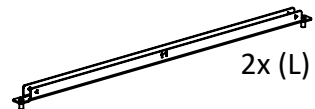
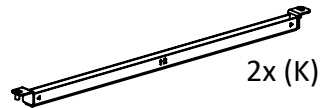
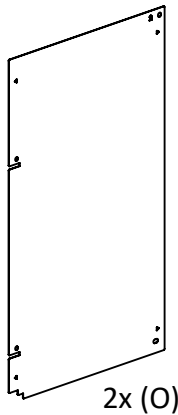
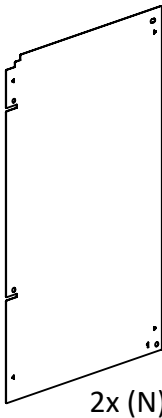
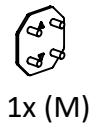
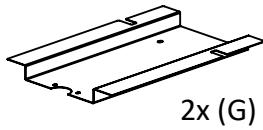
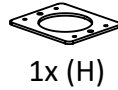
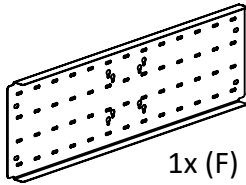



# Box content 3/3

## Fixings included for installation.



2x Flange nut M4



4x Flange nut M6



4x Flange nut M8



8x Nut M8



4x Pozi screw M4x6mm



8x Hex screw M6x8mm



4x Hex screw M6x12mm



8x Hex screw M6x6mm

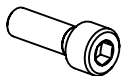

4x Hex screw M8x25mm



8x Washer M8 16x1.6mm



2x Washer 4x25mm

## Included fixings to be used for VESA/screen.

2 x Fixing bag MK10-0076 each including:



4x Washer M8 16x1.6mm



4x Spacer Ø8.4xØ15.5x5mm



4x Hex screw M8x16mm

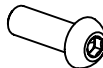

4x Hex screw M8x25mm

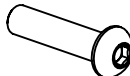

4x Hex screw M8x35mm



4x Hex screw M6x12mm

## Included optional secure screws for locking the door.



2x Secure screw M6x12mm

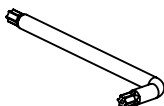

1x Secure allen key

# Dimensions [mm]

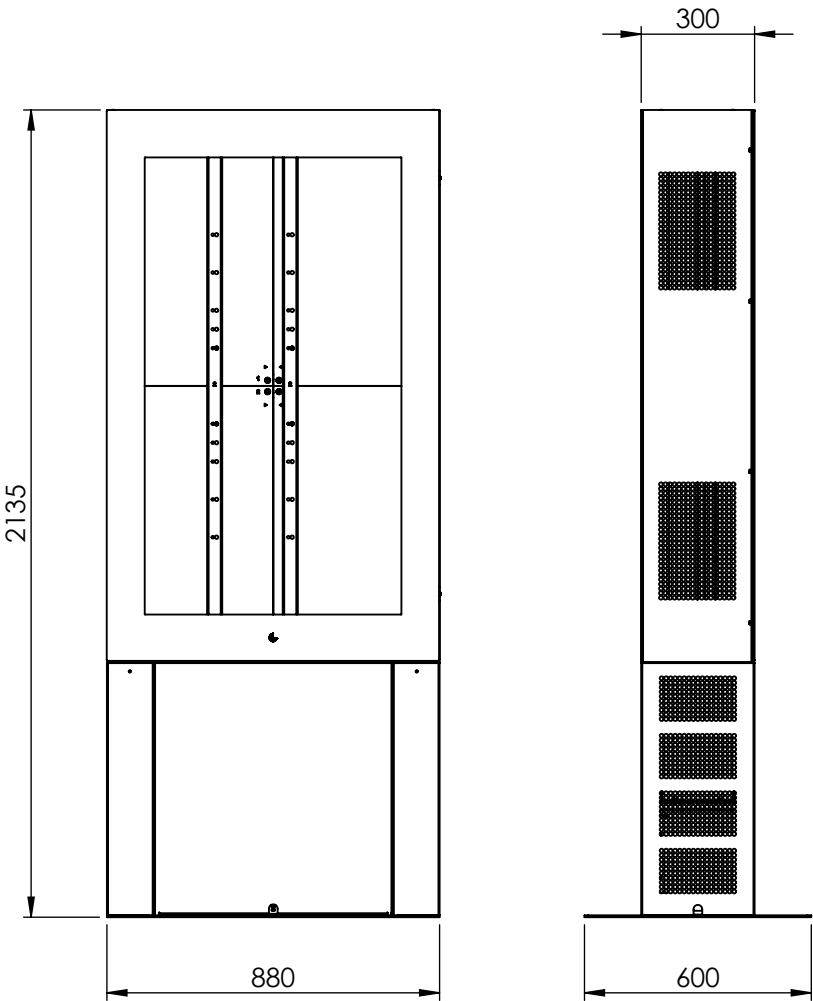

# Steps

## Step 1:

- 1 Mount the 2x **Part D** onto **Part C**. Use the mounting holes at the back, and slide them over the mounting studs.

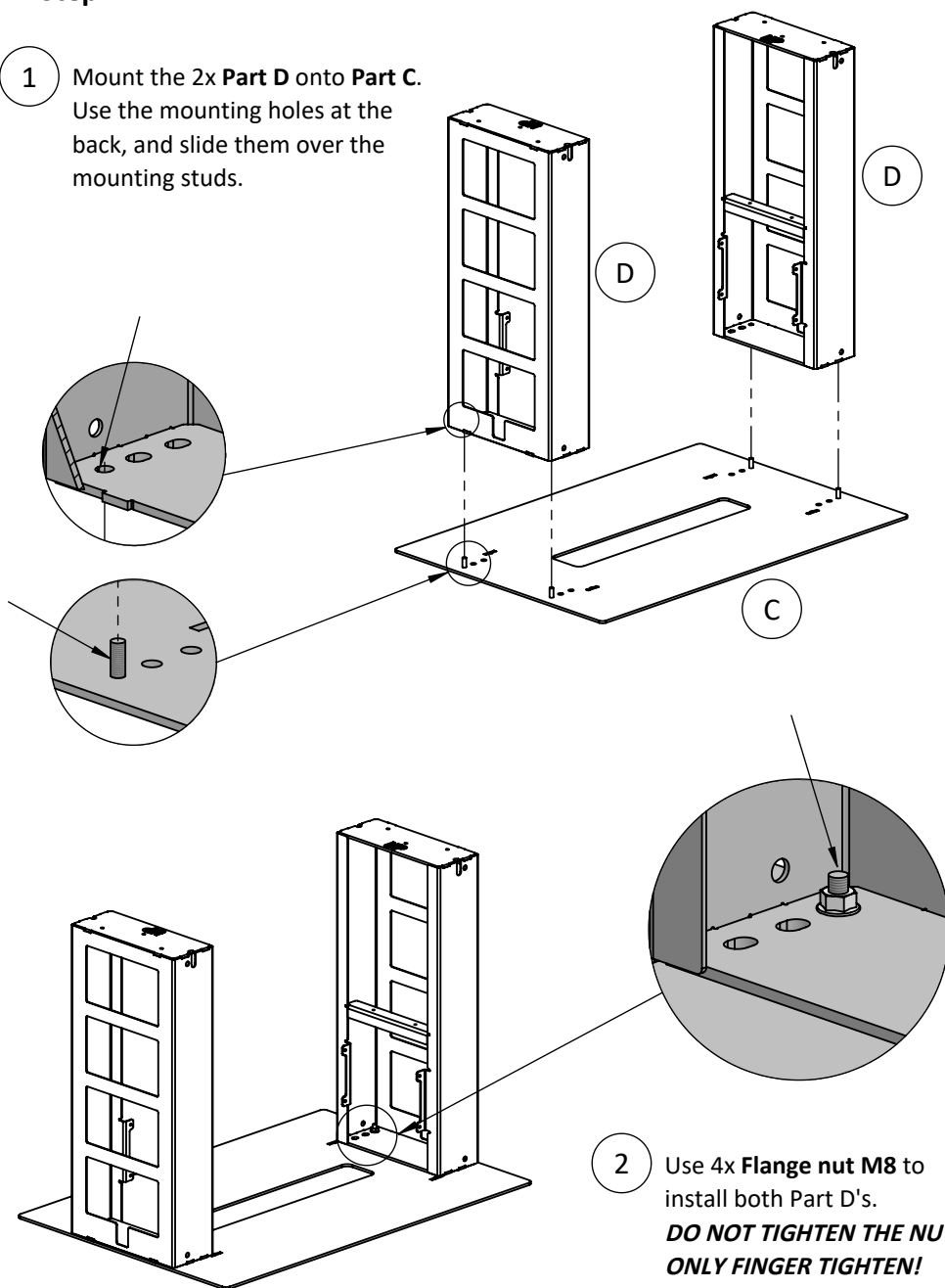

- 2 Use 4x **Flange nut M8** to install both Part D's.  
**DO NOT TIGHTEN THE NUTS!**  
**ONLY FINGER TIGHTEN!**  
**Adjustment on next step.**

# Steps

## Step 2:

- 1 Measure from the outside at both ends, and adjust the distance to reach 876 mm.

**Measure distance on both sides.**

**Only finger tighten, fully tightening and adjustment on later step necessary.**

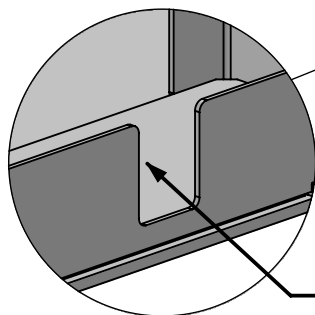
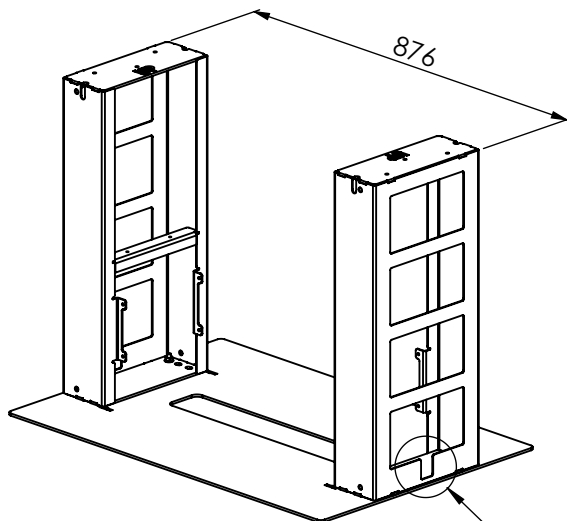

- 2 Route cables for the base module before next step.

Route cables through here.

# Steps

## Step 3:

- 1 Slide **Part B** over the assembly.  
Mind the threaded studs at both ends of the open side, they must fit into the slot on the assembly.  
*Mind the placement of **Part B**! The open side can be facing both directions. The open side must be facing the same direction as the enclosure maintenance door (installed on later step).*

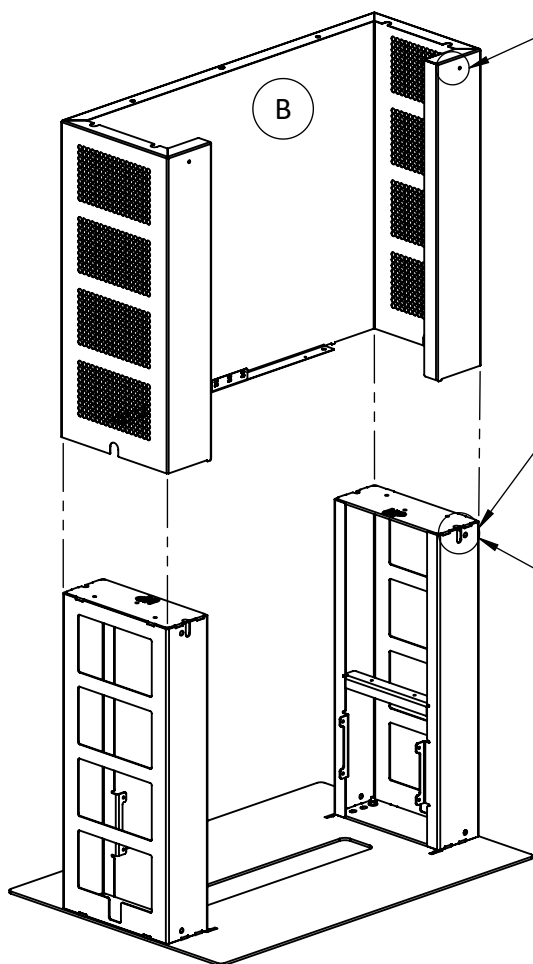
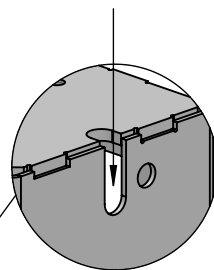
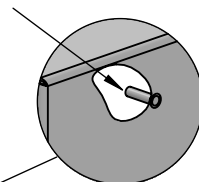

- 2 On the inside of the open end place  
2x **Flange nut M4** and  
2x **Washer 4x25mm**  
**ONLY FINGER TIGHTEN!**  
**Adjustment on later step.**

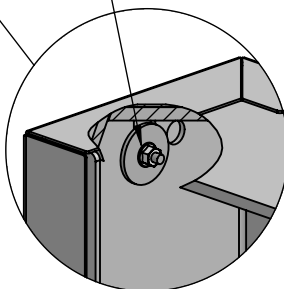

# Steps

## Step 4:

- 1 Mount **Part A** onto the assembly using the matching mounting holes. Use 4x **Hex screw M8x25mm** and 2x **Hex screw M6x12mm** to fasten the parts.

*Mind the placement of **Part A**! The maintenance door must be facing the same directing as the open side on the base unit.*

2x Hex screw  
M6x12mm

4x Hex screw  
M8x25mm

- 2 Tighten/adjust the nut accordingly to make the surface of the base module (**Part B**) flush with the top module (**Part A**).

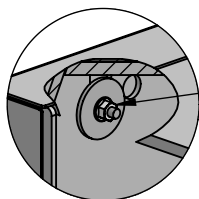

- 3 *Final adjustments may be necessary for aligning the top & base modules.*  
**Now fully tighten all screws in the base & top module.**

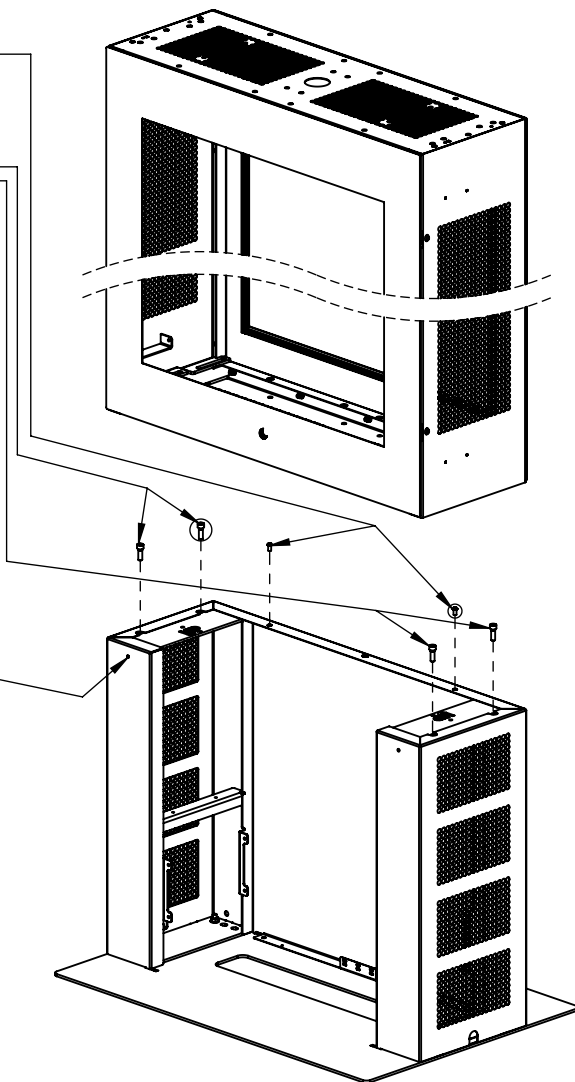

# Steps

## Step 5:

- 1 Mount **Part F** to the brackets at the back of the assembly.  
Use 4x **Hex screw M6x6mm** to fasten the part.

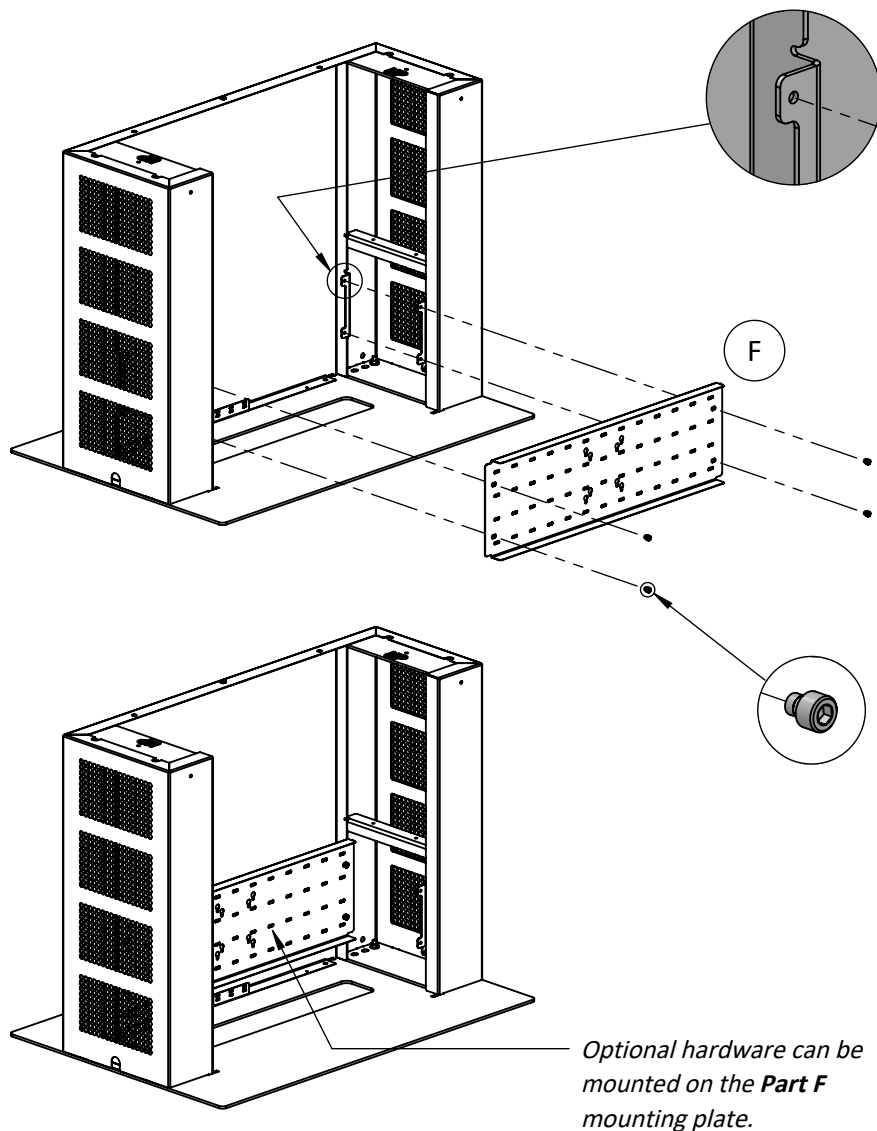

# Steps

## Step 6: (Optional)

*Separator only to be used if any hardware is mounted in the base unit on the **Part F** mounting plate.*

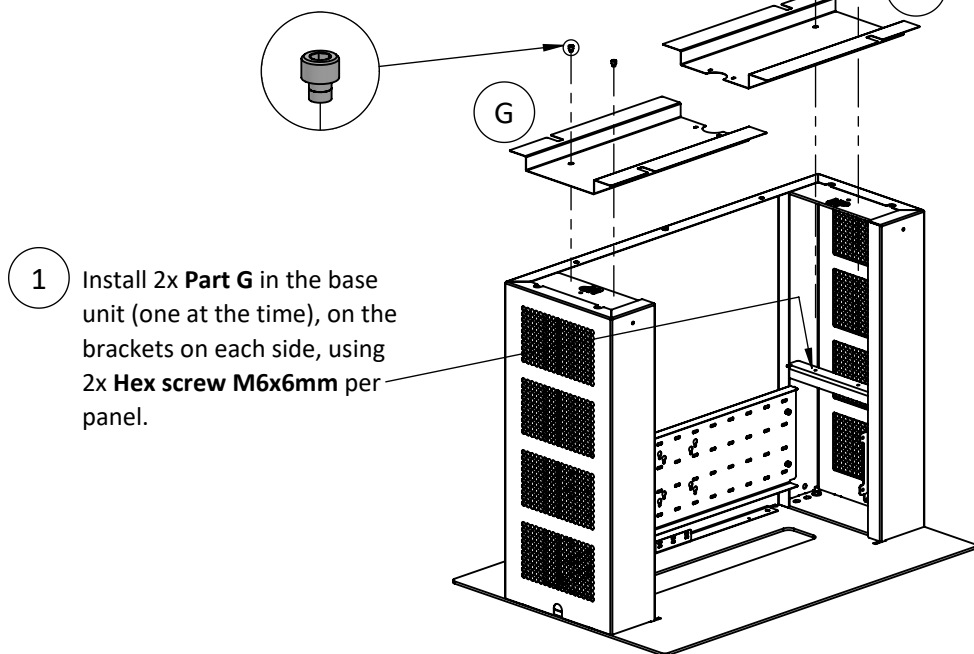

- 2 Assembly the 2x **Part G** components together with **Part H**.  
Use 4x **Pozi screw M4x6mm** to fasten the parts.

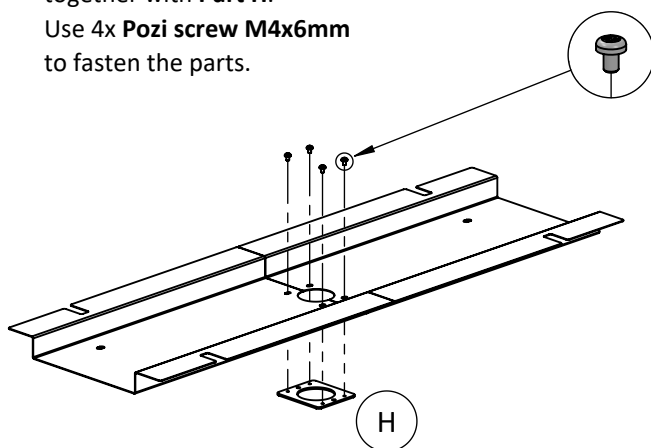



# Steps

## Step 7:

- 1 Remove the two screws on the right side of the cabinet, to open the door (*Keep the screws for locking again - optional secure screws also included*).
- 2 Mount **only** 1x **Part L** (*marked with "1" and an arrow for upwards direction*) in the enclosure at the top (*see picture at the bottom*). Use 2x **Nut M8** and 2x **Washer M8 16x1.6mm** to fasten the part.  
**ONLY FINGER TIGHTEN!**  
*Thereafter move the rail towards the center of the enclosure.*  
**Adjustment on later step.**

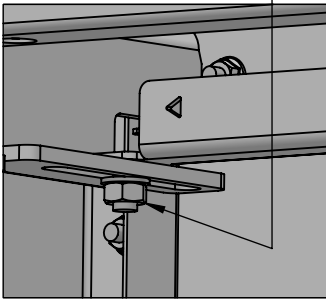
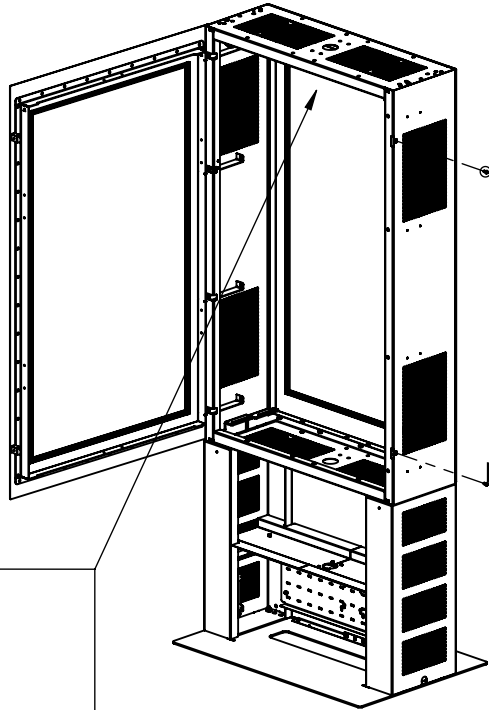
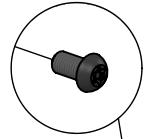

# Steps

## Step 8:

- 1 Install the vertical VESA rails 2x **Part I** (marked with "1") on screen no. 1 with the appropriate fixings, and in the correct mounting holes, according to VESA type.  
*For the following steps this will be called "Screen 1".*

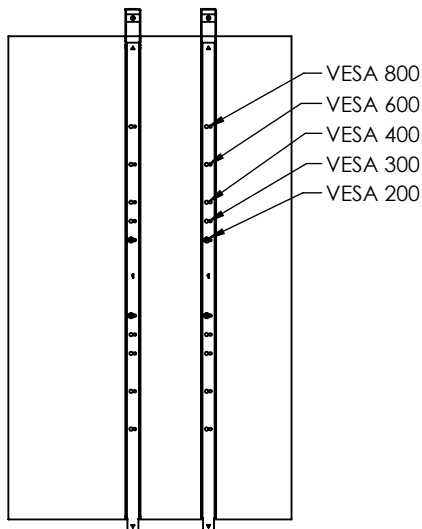
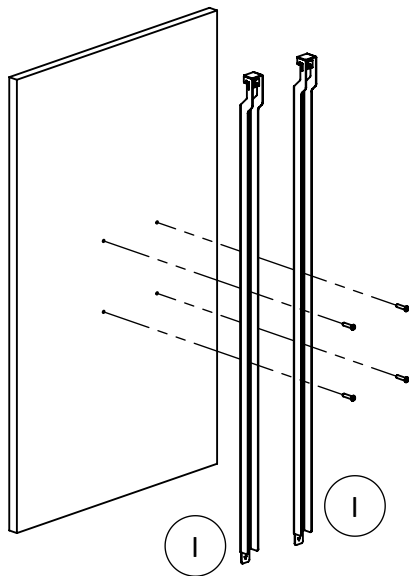

### Included fixings to be used for VESA/screen.

#### 1 x Fixing bag MK10-0076 including:



4x Washer M8 16x1.6mm



4x Spacer Ø8.4xØ15.5x5mm



4x Hex screw M8x16mm



4x Hex screw M8x25mm

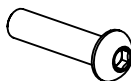

4x Hex screw M8x35mm



4x Hex screw M6x12mm

# Steps

## Step 9:

- 1 Mount the **"Screen 1"** by hanging the vertical rails on the top horizontal rail inside the enclosure.
- 2 Adjust sideways until satisfactory, and then tighten the screws on top of the vertical rails.

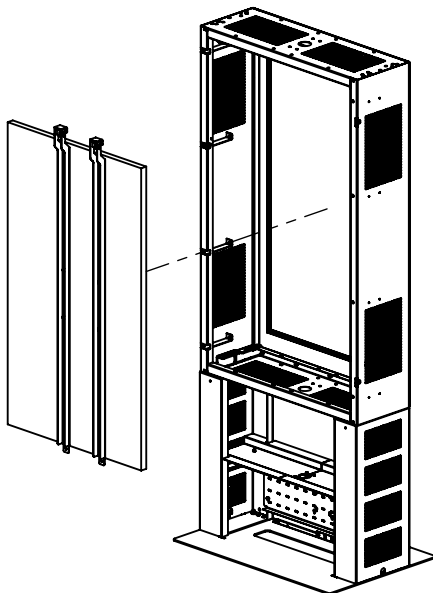
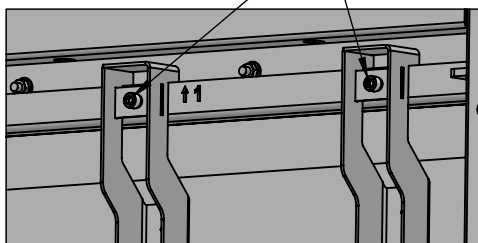

- 3 Push the screen towards the opening, until it touches the rubber padding.

- 4 Now tighten the nuts on the top vertical rail, to lock the screen in position.

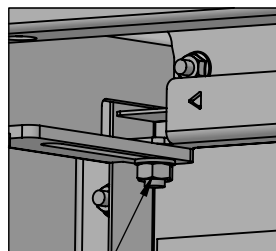

- 5 Mount the other 1x **Part L** (marked with "1" and an arrow for upwards direction) in the enclosure at the bottom. Use 2x **Nut M8** and 2x **Washer M8 16x1.6mm** to fasten the part. Push towards the bottom part of the vertical rails.

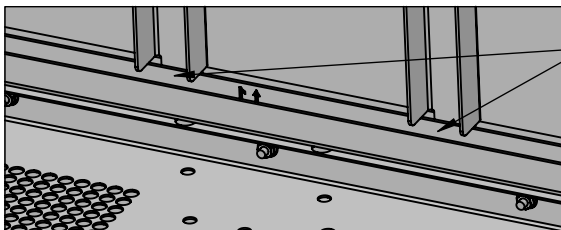

- 6 When the screen touches the rubber padding at the bottom, then tighten the nuts.

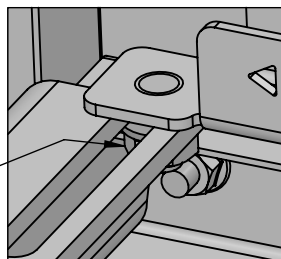

# Steps

## Step 10:

- 1 Route all necessary cables (for both screens) from the base module into the top module before continuing. Connect the cables for **"Screen 1"** now.

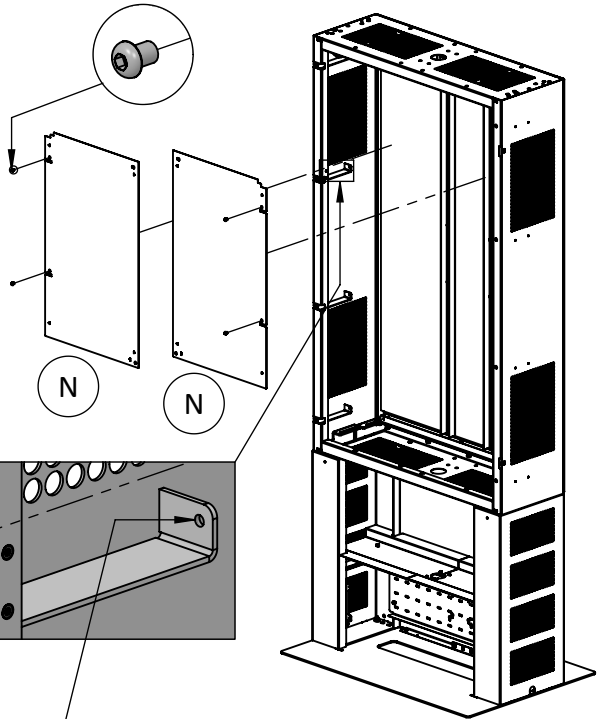

- 2 Mount the 2x **Part N** separator panels (*marked with "1"*) on the hinges at the top of the cabinet. Fasten each panel with 2x **Hex screw M6x8mm**.

- 3 Mount **Part M** from the backside of the two separator panels. Use 2x **Flange nut M6** to fasten the part.

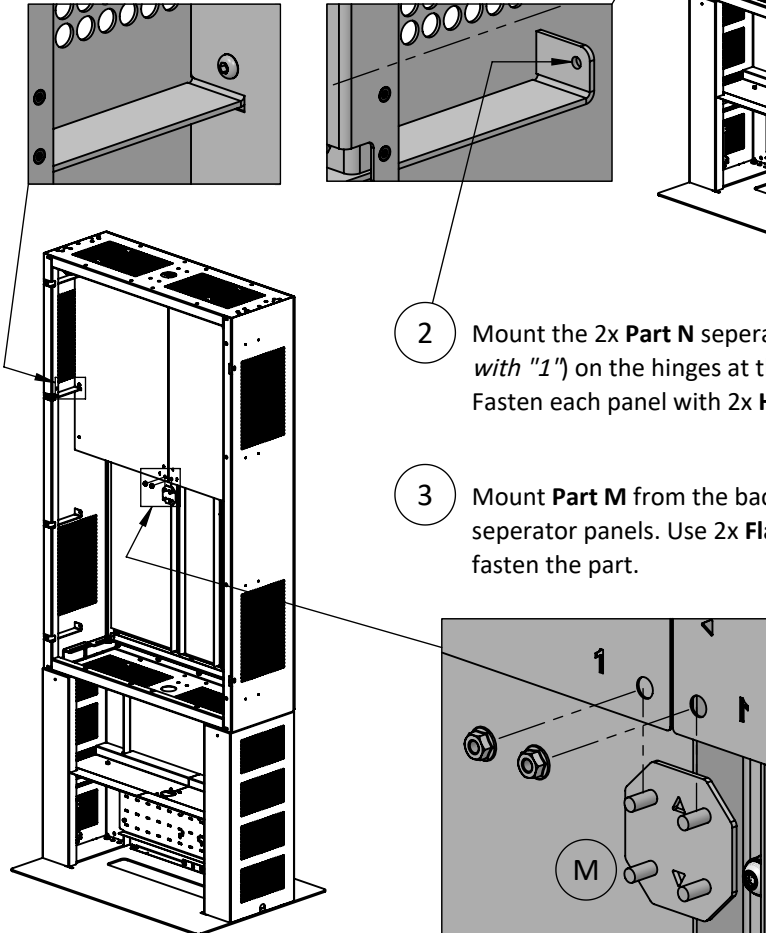

# Steps

## Step 11:

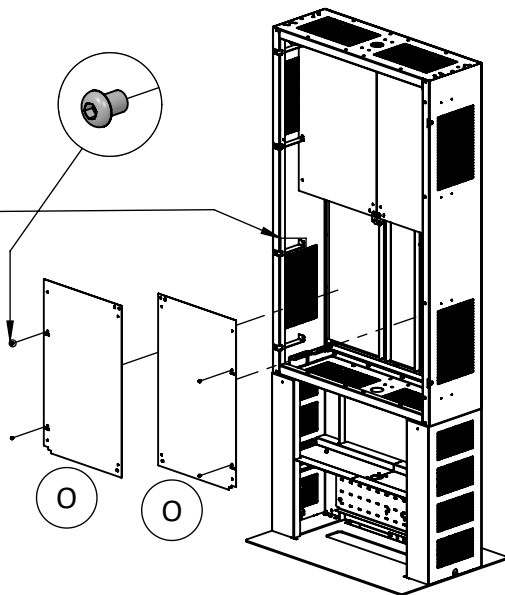
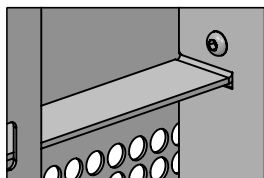
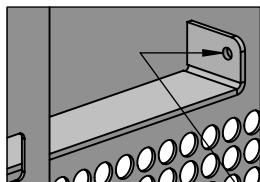

- 1 Mount the 2x **Part O** separator panels (*marked with "2"*) on the hinges at the bottom of the cabinet. Fasten each panel with 2x **Hex screw M6x8mm**.

- 2 Mount the separator panels to **Part M**. Use 2x **Flange nut M6** to fasten the parts.

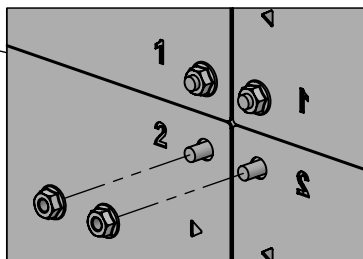
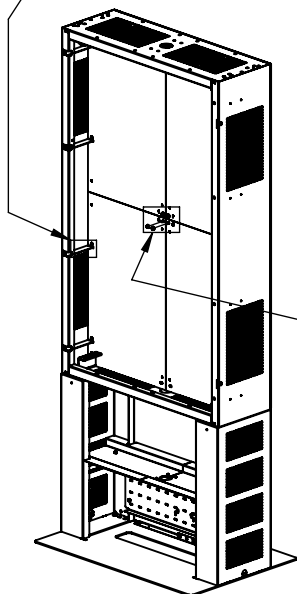

# Steps

## Step 12:

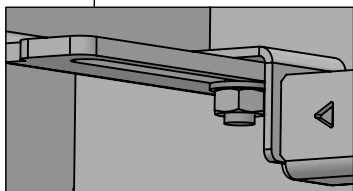
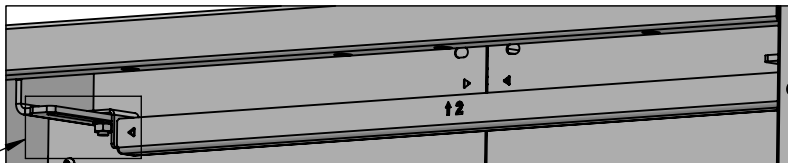

- 1 Mount 2x **Part K** (*marked with "2" and an arrow for upwards direction*) in the enclosure at the top and bottom (*see picture at the bottom*).

Use 2x **Nut M8**  
and 2x **Washer M8 16x1.6mm**  
to fasten each part.

**ONLY FINGER TIGHTEN!**  
**Adjustment on later step.**

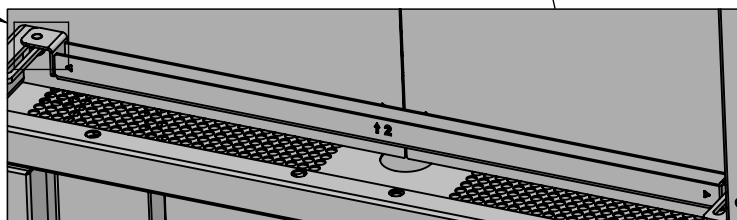
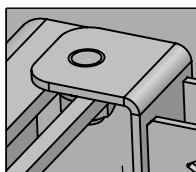
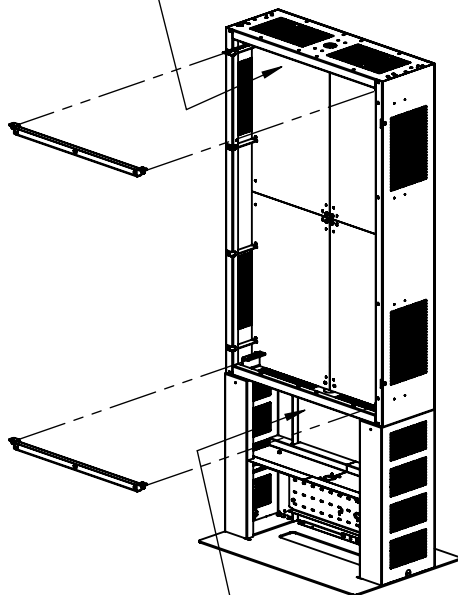

# Steps

## Step 13:

1 Measure **screen thickness (X mm)** or get value from the screen technical specification sheet.

2 Note, total adjustment is **71mm**.  
*Minimum recommended screen thickness: 28,5mm.*  
*Maximum recommended screen thickness: 89,5mm.*

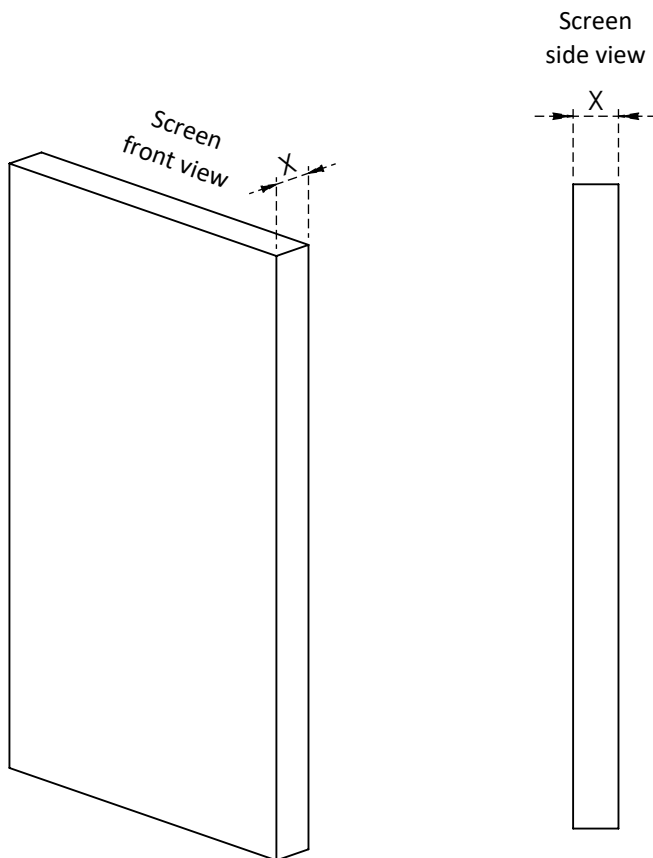

# Steps

## Step 14:

- 1 Install the vertical VESA rails 2x **Part J** (marked with "2") on screen no. 2 with the appropriate fixings, and in the correct mounting holes, according to VESA type.  
*For the following steps this will be called "Screen 2".*

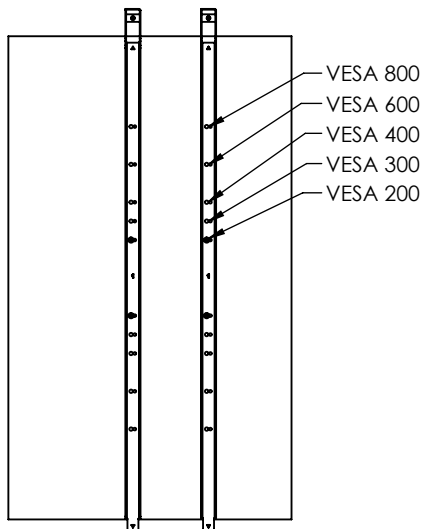
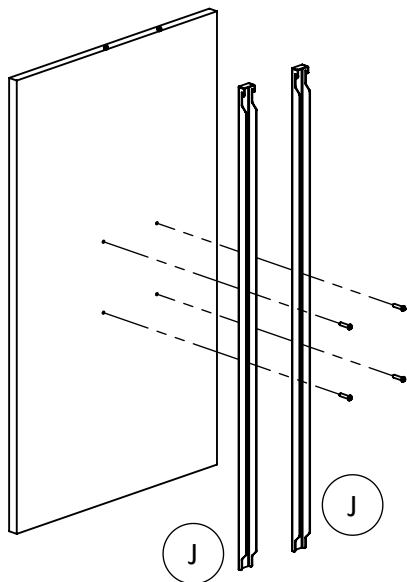

### Included fixings to be used for VESA/screen.

#### 1 x Fixing bag MK10-0076 including:



4x Washer M8 16x1.6mm



4x Spacer Ø8.4xØ15.5x5mm



4x Hex screw M8x16mm



4x Hex screw M8x25mm



4x Hex screw M8x35mm



4x Hex screw M6x12mm



# Steps

## Step 15:

1

Measure between the two highlighted surfaces, (marked with hatching) in the detailed view.

Measurement must be  $(X \text{ mm} - 29,5\text{mm}) \pm 1\text{mm}$ .

**(X = screen thickness)**

Adjust distance to the calculated above.

Repeat task for top/bottom, left/right side of both brackets.

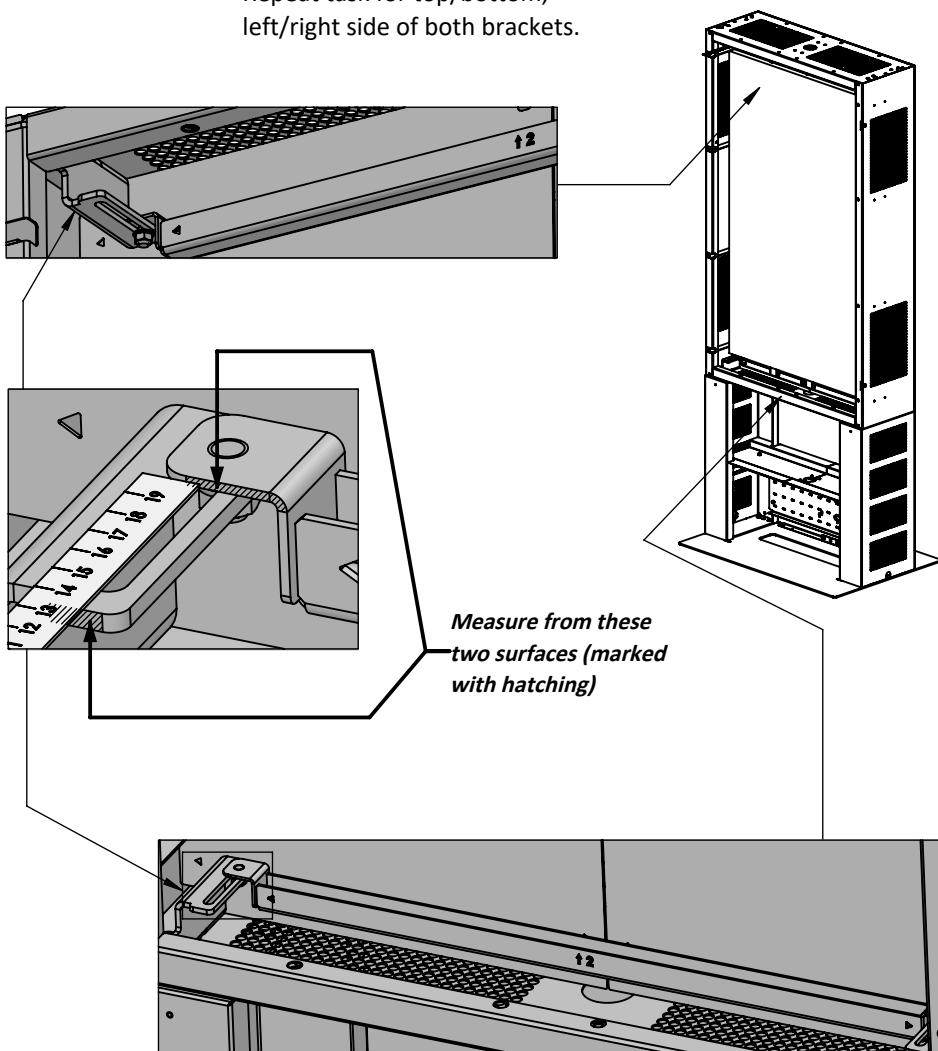

# Steps

## Step 16:

- 1 Connect all the cables to **"Screen 2"** before mounting the screen.
- 2 Mount the **"Screen 2"** by hanging the vertical rails on the top horizontal rail inside the enclosure.
- 3 Adjust sideways until satisfactory, and then tighten the screws on top of the vertical rails.

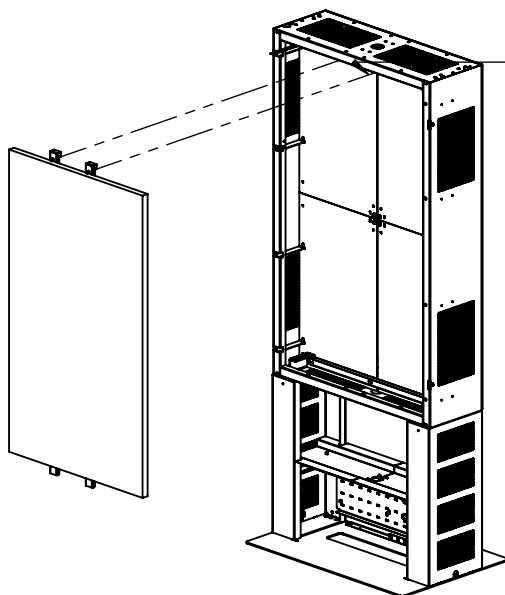
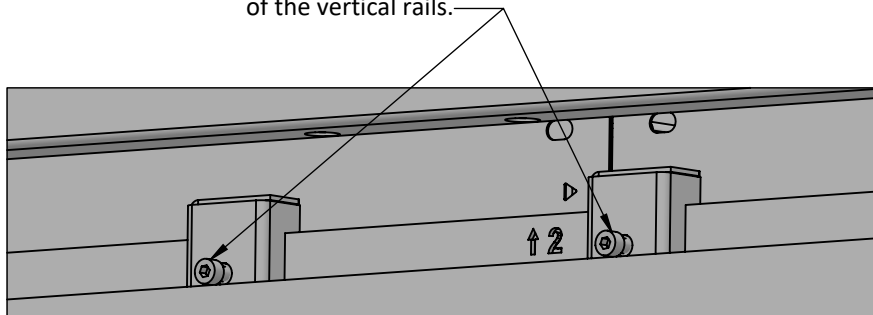

# Steps

## Step 17:

- 1 Mount **Part E** cover plate with 2x Hex screw **M6x12mm**.  
The tab in the bottom left and right corner must fit in the slot, and the screws are installed from inside the cabinet.

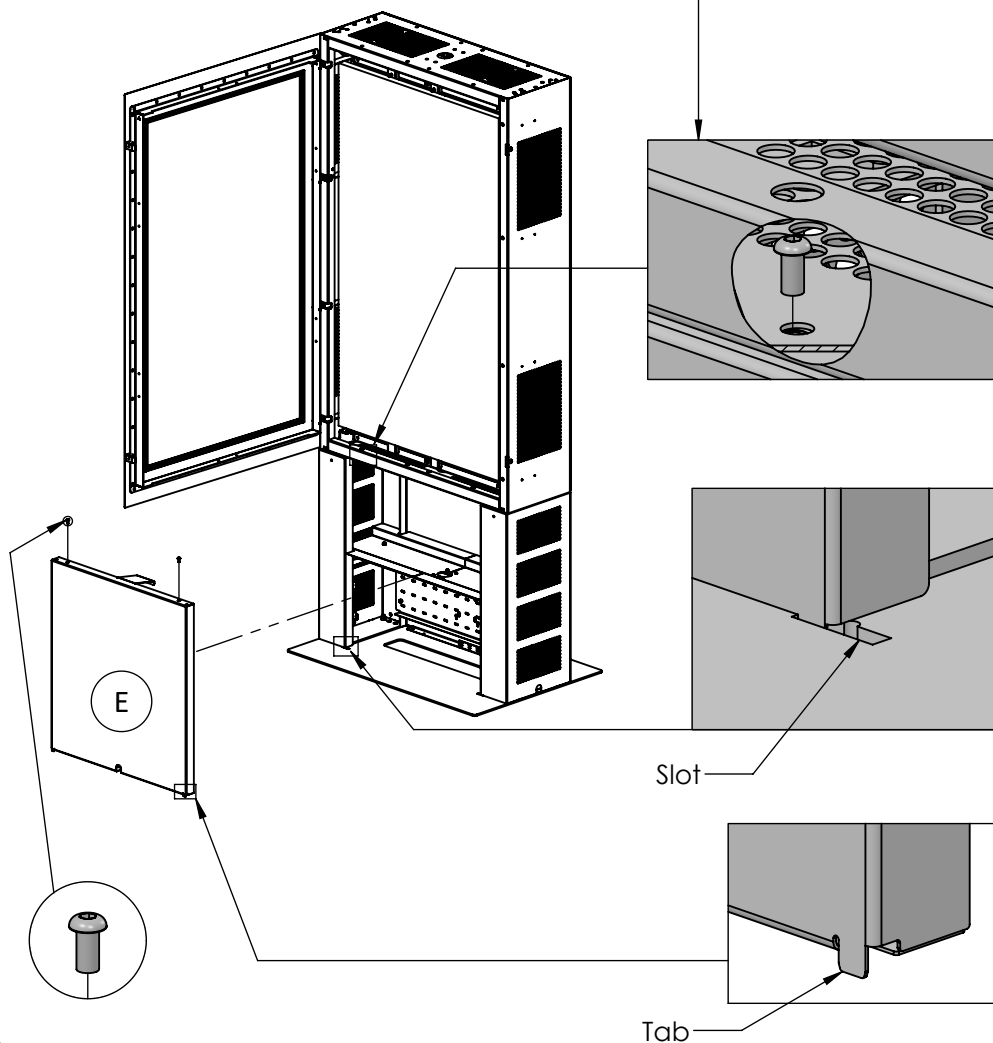

# Steps

## Step 18:

- 1 Close the door and re-install the two screws on the right side of the cabinet, to secure the door.

***Optional alternative secure screws are included, and can replace the normal screws mounted from the factory.***

- 2 The installation is now completed.

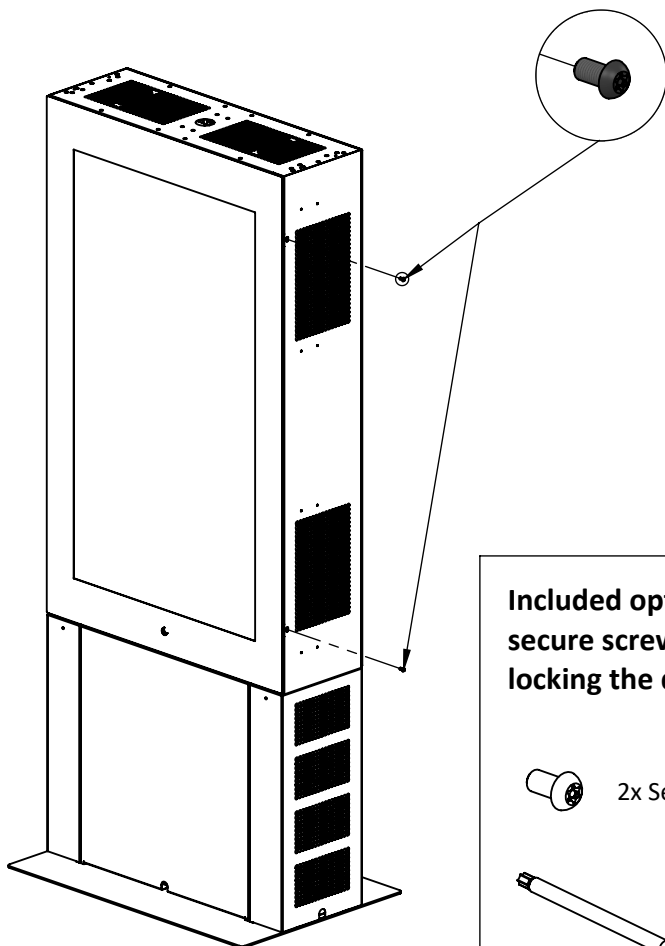

**Included optional  
secure screws for  
locking the door.**



2x Secure screw M6x12mm

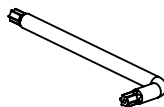

1x Secure allen key

*This page intentionally left blank*

*This page intentionally left blank*

*This page intentionally left blank*

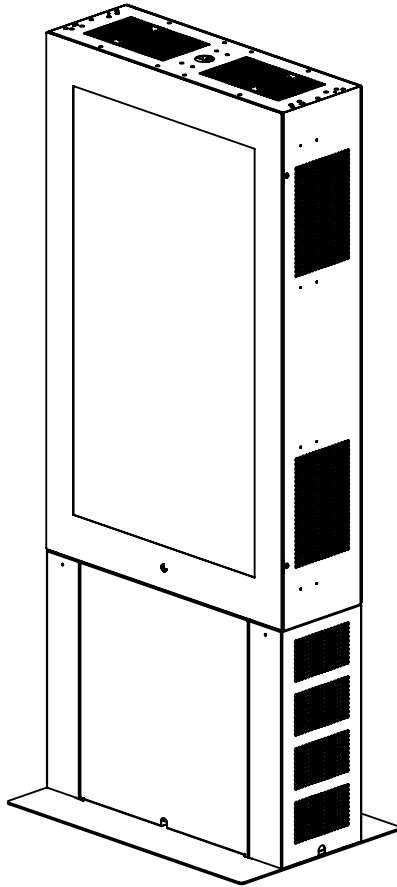

Need help? Contact us



ergonomic<sup>®</sup>  
solutions  
creators of SpacePole



spacepole<sup>®</sup>  
an ergonomic  
solutions company

[ergonomic.solutions/about/contact-us](https://ergonomic.solutions/about/contact-us)

[spacepole.com/about/contact-us](https://spacepole.com/about/contact-us)